

PROXXON

KS 230

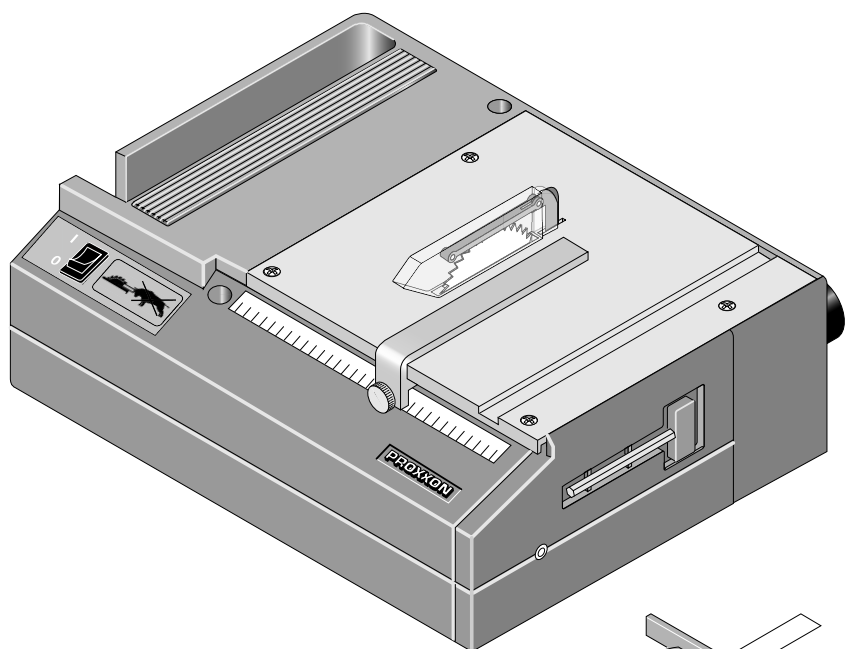

Manual

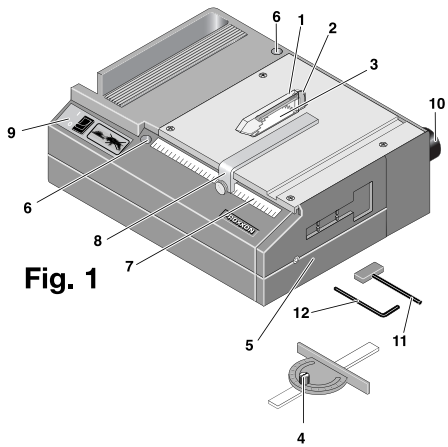

Fig. 1

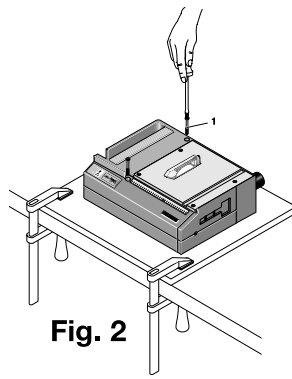

Fig. 2



Fig. 2a

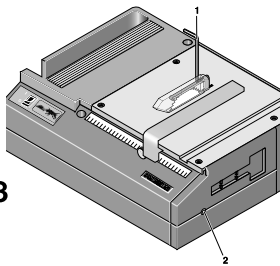

Fig. 3

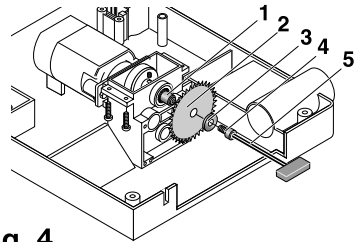

Fig. 4

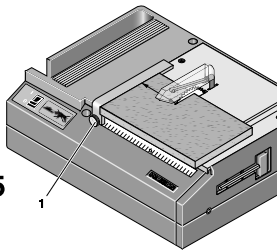

Fig. 5

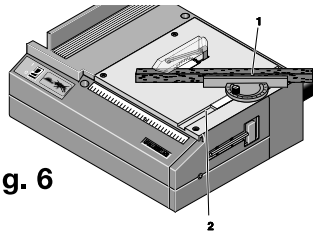

Fig. 6

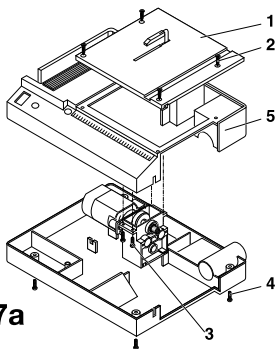

Fig. 7a

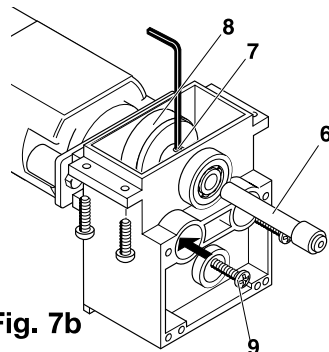

Fig. 7b



Translation of the Original Operating Instructions MICRO-Circular saw KS 230

Dear Customer,

The PROXXON MICRO-circular saw KS 230 is the ideal device for precise, even cuts in wood, plastic or non-ferrous metals. To use the saw safely and correctly, please read the attached safety regulations and control note carefully before using the device.

Please observe the supplementary safety notes when working with the KS230 micro circular saw.

1. Do not use deformed or flawed saw blades
2. Use only the saw blades recommended by the manufacturer and which correspond to EN 847-1.
3. Replace dull saw blades.
4. Make sure that the steel blade thickness of the saw blade is not greater than the thickness of the splitting wedge and that the saw blade may be used for the machine speed.
5. Saw blades made of high-alloy high-speed steel (HSS) may not be used.
6. Choose a saw blade suitable for the material to be cut.
7. Attach a dust collector if you are sawing wood.
8. The KS 230 may not be used to groove, notch or slit.
9. The upper part of the saw blade must be covered during transportation.
10. Do not leave the device unsupervised.
11. Never work without the splitting cotter or without the saw blade cover .
12. In case of wear at the sawing gap, replace the entire table top.
13. Only work on work pieces, for which the table provides a safe base, so that tilting of the work piece is prevented.
14. Only use faultless saw blades.

General view:

1. Saw blade protection
2. Splitting cotter
3. Saw blade
4. Angle stop
5. Sliding door
6. Holes for attachment
7. Adjusting scale
8. Longitudinal stop
9. On/off switch
10. Pipe union for vacuum cleaner
11. 3 mm hexagon key
12. 2 mm hexagon key

Description of the machine

The KS 230 cuts wood and similar materials up to 8 mm, plastics up to 3 mm and non-ferrous metals up to 1.5 mm. The basic equipment includes a saw blade, a longitudinal stop, an angle stop, two fixing bolts, a rubber adapter for vacuum cleaner connection as well as two hexagon keys. We recommend original PROXXON replacement saw blades.

Technical data:

Generated noise	≤ 80dB(A)
Eff. acceleration	≤ 2.5 m/s ²
Weight	1.8 kg

Dimensions

Bearing surface	160x160 mm
Max. cutting thickness	12 mm
Max. saw blade Ø	58 mm
Saw blade drill hole:	10 mm

Motor

Rotational speed	6,500/min
Voltage	220-240 Volt 50/60Hz
Power rating	85 wat

Protective insulation safety class system 2



Use only indoors



Please do not dispose off the machine!



Operation

Before start-up

Mounting the machine

The MICRO-circular saw must be fastened onto a sturdy wooden board using the enclosed fixing bolts 1 (Fig.2) The board can then be fixed onto a sturdy table using two fastening clamps.

Replacing the saw blade

Important

Before changing the saw blade, pull out the mains plug.

1. Open the sliding door 2 (Fig.3) with the hexagon key.
2. Insert 2 mm hexagon key 1 into the base plate and block the drive shaft.
3. Using the 3 mm hexagon key 5 (Fig. 4) unscrew screw 4, remove ring 3 and saw blade 2.
4. Place the new saw blade on the saw shaft 1, replace ring 3, screw in screw 4 and tighten.

Note:

The choice of the saw blade will depend on the material to be sawed.

Connecting the vacuum cleaner

For longer periods of operation, we recommend connecting the saw to a vacuum cleaner. To this end, connect the vacuum cleaner at the pipe union 10 (Fig. 1) using the attached rubber adapter.

Working with the MICRO-circular saw

Always operate the saw from the position as shown in Fig. 2a so that you are always in optimal control of the work piece. Stand in front of the saw while sawing! Never saw with your KS 230 from the side or even from the back. Ensure sufficient stability while you work!

Sawing with the longitudinal stop

1. Release the clamping screw **1** (Fig. 5), set stop and again retighten the clamping screw (the max. work piece width amounts to 70 mm).

Sawing with the angle stop

1. Release the clamping screw **1** (Fig. 6), set the angles according to the scale and retighten the clamping screw. Then push the work piece lightly against the stop and guide the stop along groove **2**.

Maintenance

Important

Pull out the mains plug prior to commencing all maintenance and repair work.

Replacing the toothed belt

If the toothed belt becomes worn it is possible to change it yourself. You can order replacement belts from the PROXXON central service.

1. Remove mains plug.
2. Remove the saw blade.
3. Unscrew screws **2** and **4** (Fig. 7a).
4. Unscrew screws **3** and remove the base plate from the transmission.
5. Release the threaded pin **7** (Fig. 7b) using 2 mm hexagon key and pull out the shaft **6**.
6. Release the motor screws **9** and remove the motor from the transmission.
7. Remove the pulley **8** and insert a new toothed belt.
8. Install the pulley **8** with toothed belt in the transmission casing.
9. Insert the toothed belts on the motor pinions and reconnect the motor to the transmission
10. The rest of the assembly follows in reverse order.

Disposal

Please do not dispose of the device in domestic waste! The device contains valuable substances that can be recycled. If you have any questions about this, please contact your local waste management enterprise or other corresponding municipal facilities.

EC Declaration of Conformity

Name and address:

PROXXON S.A.
6-10, Håreberg
L-6868 Wecker

Product designation: KS 230
Article No.: 27006

In sole responsibility, we declare that this product conforms to the following directives and normative documents:

EU EMC Directive **2004/108/EC**
DIN EN 55014-1 / 02.2010
DIN EN 55014-2 / 06.2009
DIN EN 61000-3-2 / 03.2010
DIN EN 61000-3-3 / 06.2009

EU Machinery Directive **2006/42/EC**
DIN EN 61029-1 / 01.2010
DIN EN 61029-2-1 / 12.2002
DIN EN ISO 14121-1/12.2007

Date: 15.09.2010



Dipl.-Ing. Jörg Wagner

PROXXON S.A.
Machine Safety Department

The CE document authorized agent is identical with the signatory.

KS 230
Art No. 27 006

ET-Nr.:

27006 - 01	Housing top part
27006 - 02	Housing bottom part
27006 - 03	Cover
27006 - 04	Gearbox casing
27006 - 05	Bearing bush
27006 - 06	Motor with mounting plate and pinion
27006 - 07	Fastening screw for motor
27006 - 08	Fastening screw for gearbox
27006 - 09	Switch
27006 - 10	220 Volt connecting cable with plug
27006 - 11	Worktop
27006 - 12	Mitre gauge complete
27006 - 15	Screw for worktop
27006 - 16	Longitudinal stop complete
27006 - 18	Pin
27006 - 21	Fastening for splitting wedge (completely)
27006 - 25	Toothed belt pulley with threaded rod
27006 - 26	Shaft
27006 - 28	Disc
27006 - 29	Fastening screw for saw blade
27006 - 30	Allen wrench
27006 - 56	Ball bearing
27006 - 57	Toothed belt wheel
27006 - 59	Fastening screw
27006 - 60	Adapter for vacuum cleaner connection
27006 - 62	Coil spring
27006 - 63	Latch
27006 - 64	Pin
27006 - 65	Strain relief
27006 - 66	Screw for strain relief
27006 - 71	Splitting wedge
27006 - 72	Rod
27006 - 73	Saw blade cover
27006 - 74	Pin
27006 - 75	Label
27006 - 97	Article packaging
27006 - 99	Operating instructions (with safety regulations)

